

APLICACIONES

Para agua y líquidos neutros, aguas residuales con una velocidad de flujo no mayor a 16Ft/s (4.9m/s).

MATERIALES Y NORMAS:

ANSI/AWWA C110/ A21.10

Hierro gris clase 30B ASTM A48 / A126-B.

Hierro nodular ASTM a 395 y A536

RANGO DE TRABAJO:

250 PSI para piezas de 2-12 in.

150 PSI para piezas 14 - 36

0.6°C-52°C (33°F-125°F).

CAPACIDAD NOMINAL	DENOMINACIONES GENERALES (EN PULGADAS)					PESO (KILOGRAMOS)				
	IN	H	J	T	T1	L1	L2	TEE	CRUZ	REDUCCIÓN
24 x 4	15	19	0.89	0.52	30	24	377	388	204	-
24 x 6	15	19	0.89	0.55	30	24	383	396	206	-
24 x 8	15	19	0.89	0.6	30	24	390	405	209	-
24 x 10	15	19	0.89	0.66	30	24	399	421	213	-
24 x 12	15	19	0.89	0.75	30	24	403	435	217	-
24 x 14	15	19	0.89	0.66	30	24	408	442	222	-
24 x 16	15	19	0.89	0.7	30	24	414	458	238	-
24 x 18	22	22	0.89	0.75	44	24	553	618	249	-
24 x 20	22	22	1.16	1.03	44	24	684	768	267	-
24 x 24	22	22	1.16	1.16	44	24	718	838	-	-
30 x 8	18	23	1.03	0.6	36	30	660	683	683	-
30 x 10	18	23	1.03	0.68	36	30	667	690	690	-
30 x 12	18	23	1.03	0.75	36	30	675	709	709	-
30 x 14	18	23	1.03	0.66	36	30	675	711	711	-
30 x 16	18	23	1.03	0.7	36	30	682	727	727	-
30 x 18	18	23	1.03	0.75	36	30	686	732	732	-
30 x 20	18	23	1.03	0.8	36	30	698	757	757	-
30 x 24	25	25	1.38	1.16	50	30	1121	1221	1221	-
30 x 30	25	25	1.38	1.38	50	30	1185	1345	1345	-
36 x 8	20	26	1.15	0.6	40	36	963	989	508	-
36 x 10	20	26	1.15	0.68	40	36	970	1001	512	-
36 x 12	20	26	1.15	0.75	40	36	983	1015	518	-
36 x 14	20	26	1.15	0.66	40	36	985	1015	524	-
36 x 16	20	26	1.15	0.7	40	36	990	1028	535	-
36 x 18	20	26	1.15	0.75	40	36	992	1033	546	-
36 x 20	20	26	1.15	0.8	40	36	1001	1053	557	-
36 x 24	20	26	1.15	0.89	40	36	1022	1089	609	-
36 x 30	28	28	1.58	1.38	56	36	1696	1823	704	-
36 x 36	28	28	1.58	1.58	56	36	1780	1995	-	-

RECUBRIMIENTO:

Pintura acrilalquídica

ANSI-AWWA C550

CAPACIDAD NOMINAL	DENOMINACIONES GENERALES (EN PULGADAS)						PESO (KILOGRAMOS)			
	IN	H	J	T	T1	L1	L2	TEE	CRUZ	REDUCCIÓN
2 x 2	4.5	4.5	0.35	0.35	9	-	-	10	12	-
2 1/2 x 2	5	5	0.35	0.35	10	-	-	12	13	-
2 1/2 x 2 1/2	5	5	0.35	0.35	10	-	-	13	15	-
3 x 2	5.5	5.5	0.48	0.35	11	6	16	20	7	-
3 1/2 x 2	5.5	5.5	0.48	0.35	11	6	17	21	9	-
3 x 3	5.5	5.5	0.48	0.48	11	-	-	18	23	-
4 x 2	6.5	6.5	0.52	0.35	13	7	23	27	10	-
4 x 2 1/2	6.5	6.5	0.52	0.35	13	7	25	29	13	-
4 x 3	6.5	6.5	0.52	0.48	13	7	27	32	14	-
4 x 4	6.5	6.5	0.52	0.52	13	-	-	29	36	-
6 x 2	8	8	0.55	0.35	16	9	36	39	14	-
6 x 2 1/2	8	8	0.55	0.35	16	9	37	41	17	-
6 x 3	8	8	0.55	0.48	16	9	38	43	18	-
6 x 4	8	8	0.55	0.52	16	9	41	50	20	-
6 x 6	8	8	0.55	0.55	16	-	-	43	54	-
8 x 3	9	9	0.6	0.48	18	11	60	65	27	-
8 x 4	9	9	0.6	0.52	18	11	63	70	29	-
8 x 6	9	9	0.6	0.55	18	11	66	75	34	-
8 x 8	9	9	0.6	0.6	18	-	-	70	88	-
10 x 3	11	11	0.68	0.48	22	12	88	93	37	-
10 x 4	11	11	0.68	0.52	22	12	93	100	38	-
10 x 6	11	11	0.68	0.55	22	12	97	109	41	-
10 x 8	11	11	0.68	0.8	22	12	102	120	50	-
10 x 10	11	11	0.8	0.8	22	-	-	122	149	-
12 x 3	12	12	0.75	0.48	24	14	129	136	53	-
12 x 4	12	12	0.75	0.52	24	14	131	140	54	-
12 x 6	12	12	0.75	0.55	24	14	134	145	59	-
12 x 8	12	12	0.75	0.6	24	14	140	156	66	-
12 x 10	12	12	0.88	0.8	24	14	163	188	77	-
12 x 12	12	12	0.88	0.88	24	-	-	174	208	-

CAPACIDAD NOMINAL	DENOMINACIONES GENERALES (EN PULGADAS)						PESO (KILOGRAMOS)			
	IN	H	J	T	T1	L1	L2	TEE	CRUZ	REDUCCIÓN
14 x 4	14	14	0.66	0.52	28	16	166	176	69	-
14 x 6	14	14	0.55	0.55	28	16	170	181	70	-
14 x 8	14	14	0.66	0.6	28	16	177	193	79	-
14 x 10	14	14	0.66	0.66	28	16	181	208	88	-
14 x 12	14	14	0.82	0.75	28	16	212	251	100	-
14 x 14	14	14	0.82	0.82	28	-	-	226	270	-
16 x 4	15	15	0.7	0.52	30	18	208	216	85	-
16 x 6	15	15	0.7	0.52	30	18	211	22	86	-
16 x 8	15	15	0.7	0.6	30	18	215	236	95	-
16 x 10	15	15	0.7	0.68	30	18	224	251	106	-
16 x 12	15	15	0.7	0.75	30	18	238	274	120	-
16 x 14	15	15	0.89	0.82	30	18	276	317	127	-
16 x 16	15	15	0.89	0.89	30	18	288	342	-	-
18 x 4	13	15.5	0.75	0.52	26	19	211	220	107	-
18 x 6	13	15.5	0.75	0.55	26	19	218	229	108	-
18 x 8	13	15.5	0.75	0.6	26	19	221	242	109	-
18 x 10	13	15.5	0.75	0.68	26	19	231	254	120	-
18 x 12	13	15.5	0.75	0.75	26	19	242	276	134	-
18 x 14	16.5	16.5	0.75	0.86	30	19	285	326	140	-
18 x 16	16.5	16.5	0.96	0.89	30	19	344	399	154	-
18 x 18	16.5	16.5	0.96	0.96	30	19	355	414	-	-
20 x 4	11	17	0.8	0.52	28	20	270	282	131	-
20 x 6	14	17	0.8	0.55	28	20	276	288	134	-
20 x 8	14	17	0.8	0.6	28	20	281	301	137	-
20 x 10	14	17	0.8	0.68	28	20	288	310	140	-
20 x 12	14	17	0.8	0.75	28	20	300	333	156	-
20 x 14	14	17	0.8	0.66	28	20	301	337	161	-
20 x 16	18	18	0.8	.7	36	20	367	414	177	-
20 x 18	18	18	1.03	0.96	36	20	437	498	186	-
20 x 20	18	18	1.03	1.03	36	20	455	532	-	-

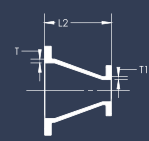
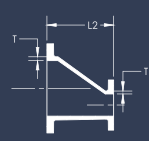
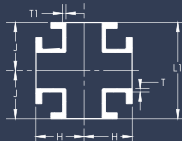
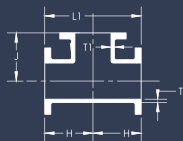

Avenida del valle de manzanares 1404, Bodega 7.
Parque Manzanares. CP 37510, León, Gto.

T. 7 17 05 82 - 170 17 16 - 170 17 15
Bridova.com.mx